

[REDACTED]

---

**From:** system@acelo.com on behalf of JACKSON WONG [REDACTED]  
**Sent:** Tuesday, 30 October 2018 10:01 PM  
**To:** [REDACTED]  
**Subject:** Submission Details for JACKSON WONG (comments)

Confidentiality Requested: no

Submitted by a Planner: no

Disclosable Political Donation:

Agreed to false or misleading information statements: yes

Name: JACKSON WONG

Email: [REDACTED]

Address:

[REDACTED]

[REDACTED]

Content:

Dear Our Honourable Planning Minister and Our Noble Planning Team,

After engaging in some research regarding my mothers property at [REDACTED] Kemps Creek NSW 2178, I have realised that we are not affected by 1 in 100 year flood. Please see image 1. We are actually affected by the medium and low flood risk lines. Chance of flooding on our property is much less than 1 in 100.

Please see the attached document.

IP Address: - 101.164.107.128

Submission: Online Submission from JACKSON WONG (comments)

[https://majorprojects.acelo.com/?action=view\\_activity&id=291147](https://majorprojects.acelo.com/?action=view_activity&id=291147)

Submission for Job: #9552

[https://majorprojects.acelo.com/?action=view\\_job&id=9552](https://majorprojects.acelo.com/?action=view_job&id=9552)

Site: #0

[https://majorprojects.acelo.com/?action=view\\_site&id=0](https://majorprojects.acelo.com/?action=view_site&id=0)

This email is missing attachments because they were too large to send. Please contact JACKSON WONG to retrieve them, or reply to this email.

Author: [REDACTED]  
Created: 30 October 2018 8:22:12 pm  
Updated: 30 October 2018 9:58:35 pm

Notebook: ACTION PENDING

Dear Our Honourable Planning Minister and Our Noble Planning Team,

After engaging in some research regarding my mothers property at [REDACTED] Kemps Creek NSW 2178, I have realised that we are not affected by 1 in 100 year flood. Please see image 1. We are actually affected by the medium and low flood risk lines. Chance of flooding on our property is much less than 1 in 100.

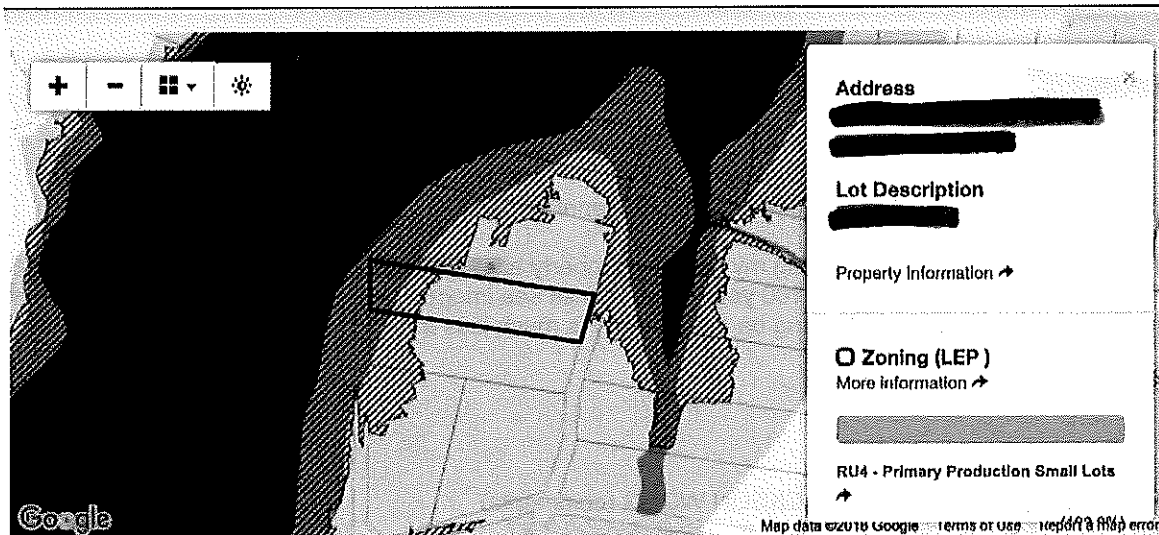

Area (approx.): 20235.18m<sup>2</sup>

## Applicable Planning Maps

The following maps apply to the selected land. Click on the list below to display the planning map.

Zoning (LEP)	RU4 - Primary Production Small Lots	100%
Minimum Lot Size (LEP)	AB1 - 10 ha	100%
Flood Risk Category	Low flood risk	86%
Flood Risk Category	Medlum flood risk	14%
LGA Wide Flood Map	Flood Planning Area (1% AEP flood plus 0.5 metre freeboard)	26%
Bushfire Prone Land	Vegetation Buffer	11%
Zoning (LEP)	RU4 - Primary Production Small Lots	100%

IMAGE 1

Using LIVERPOOL COUNCIL PLANNING WEBSITE (see below <https://eplanning.liverpool.nsw.gov.au/P.../lcc.maps/maps.aspx>) and GOOGLE MAPS, I have found countless urban property regions similar to my mothers land, in the low and medium flood risk flood zones, with countless number of residential property within these zones.

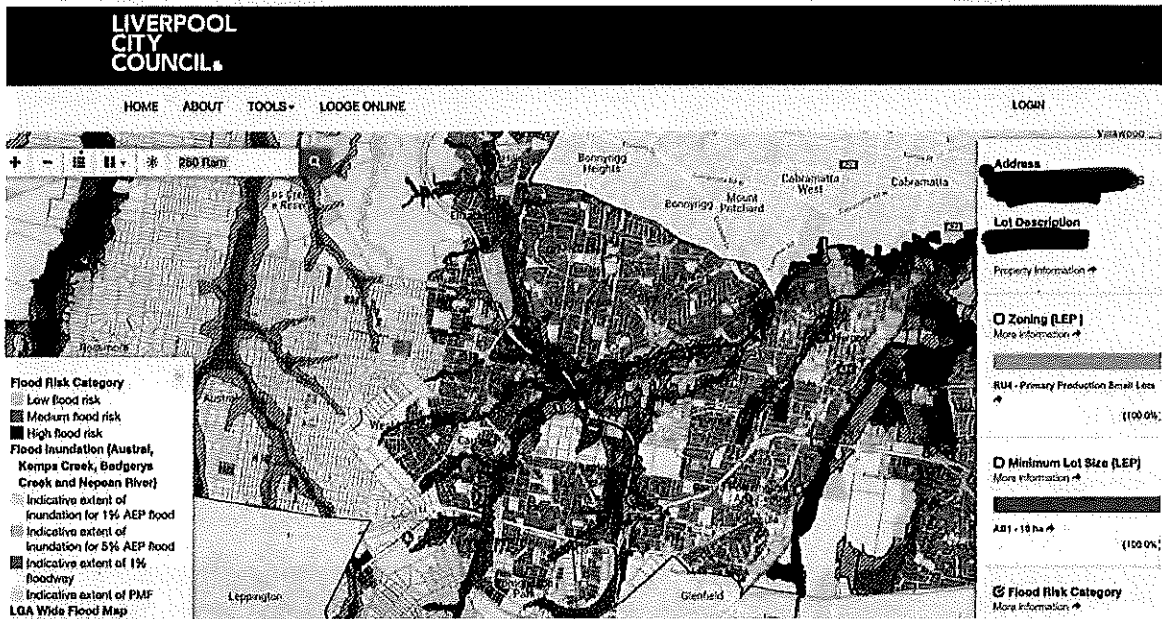

**Example 1 Chipping Norton.** Please see the below image 2.



**IMAGE 2**

**Example 2 Moorebank.** Please see the below image 3.



IMAGE 3

**Example 3 Hoxton Park.** Please see the below image 4.

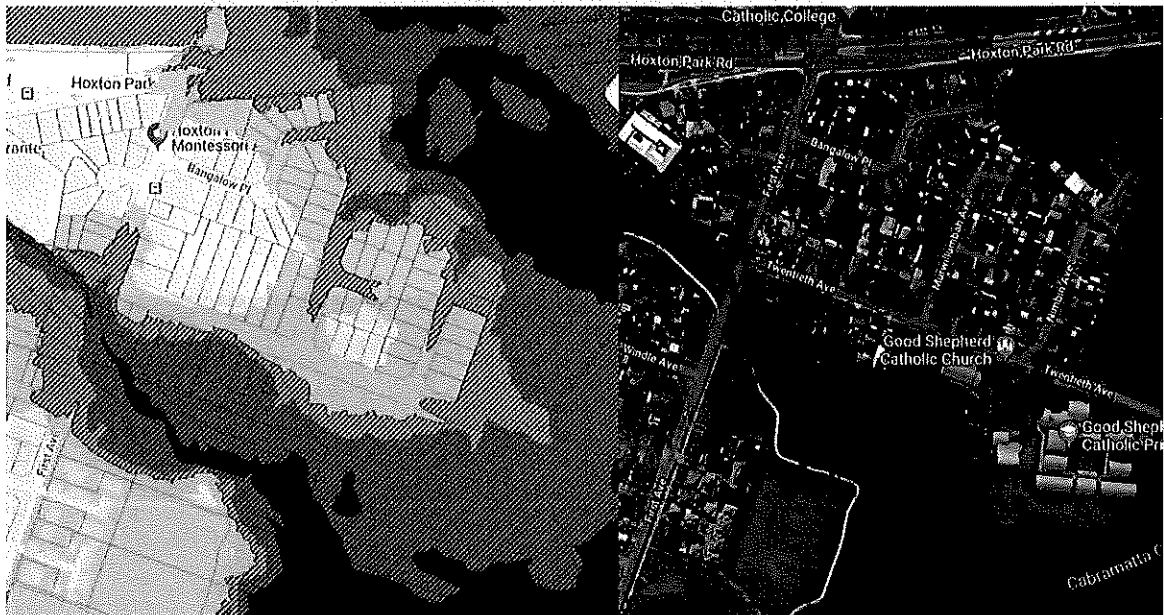

IMAGE 4

It is with these precedence set in the rest of Liverpool's Council area, that I urge you to remove the "Non Urban Land" status that you've placed on my mothers land. Please render our land urban like the adjacent "Urban" region.

Thank you kindly  
Dr Jackson Wong



10/10/10